

O10-S290

Vandal resistant LED luminaire for ceilings and walls



O10-S290 Alu



O10-S290-X Alu



O10-S290-E Alu



O10-S290 Black



O10-S290-E Black



O10-S290-X Black



O10-S290 White



O10-S290-E White



O10-S290-X White

O10-S290

Vandal resistant LED luminaire for ceilings and walls



GLAMOX



LUXONIC

Description

Glamox O10-S290 is a vandal resistant LED luminaire for ceiling and wall. Suitable both for residential or commercial use. Typical applications for Glamox O10-S290 would be facades, staircases and entrance areas. The luminaire housing is in diecast aluminium with polycarbonate diffuser.

Three designs. Three colours.

Available in three different designs; eyelid, cross or standard. Select between three different colours; black, white or aluminium grey.

Technical description

Light source	LED 500 - 1000 lumen out Colour temperature 3000/4000 K, CRI Ra 80, MacAdams 3	Connection	5 pole 2.5 mm ² push-in terminal block prepared for through wiring.
Driver	Fixed output or DALI dimable AC driver (light modulation with a frequency of 100Hz)		Outdoor use requires suitable flexible cables assuring the water tightness of the membrane gland.
Body material & colour	Housing in diecast aluminium, painted in polyester powder paint in colour black (RAL 9005), white (RAL9010) or aluminium grey (RAL 9006). Diffuser in impact resistant opal polycarbonate, IK10+ (120 Joule).	Integrated emergency light	O10-S290 can be supplied with emergency lighting system
		Integrated sensors	Twilight sensor type STA-SEN. On/off depending on daylight. Microwave Twilight sensor type SMA-SEN. Presence detection with 5 minutes hold time and on/off depending on daylight. Microwave Twilight sensor with corridor function type SMM-SEN. 100% light during presence, 10% light after 10 minutes of absence and off after 10 minutes. On/off depending on daylight. Master-slave configured for up to totally 11 luminaires and up to 5 masters. One master-slave system can cover a maximum corridor length of approximately 35 metres.

O10-S290

Vandal resistant LED luminaire for ceilings and walls



Measurement drawings

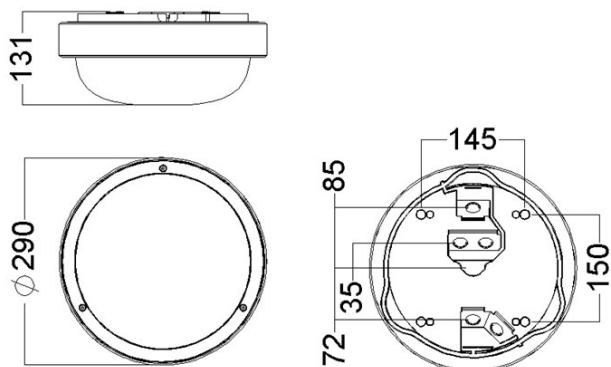

O10-S290

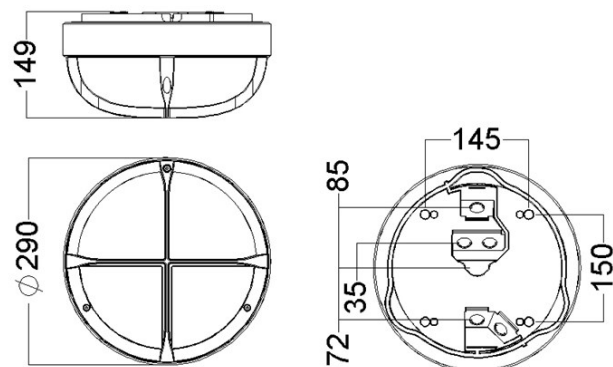

O10-S290-E

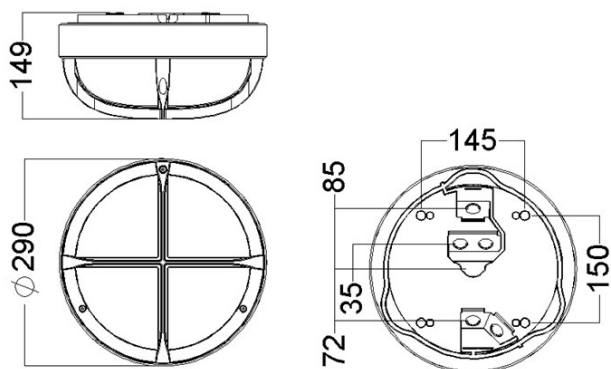

O10-S290-X

Vandal resistant LED luminaire for ceilings and walls

Light measurement drawings

